



South  
Nottinghamshire  
Academy

*The journey to South Nottinghamshire Academy*

# Year 6 Parents Information

## June 2025

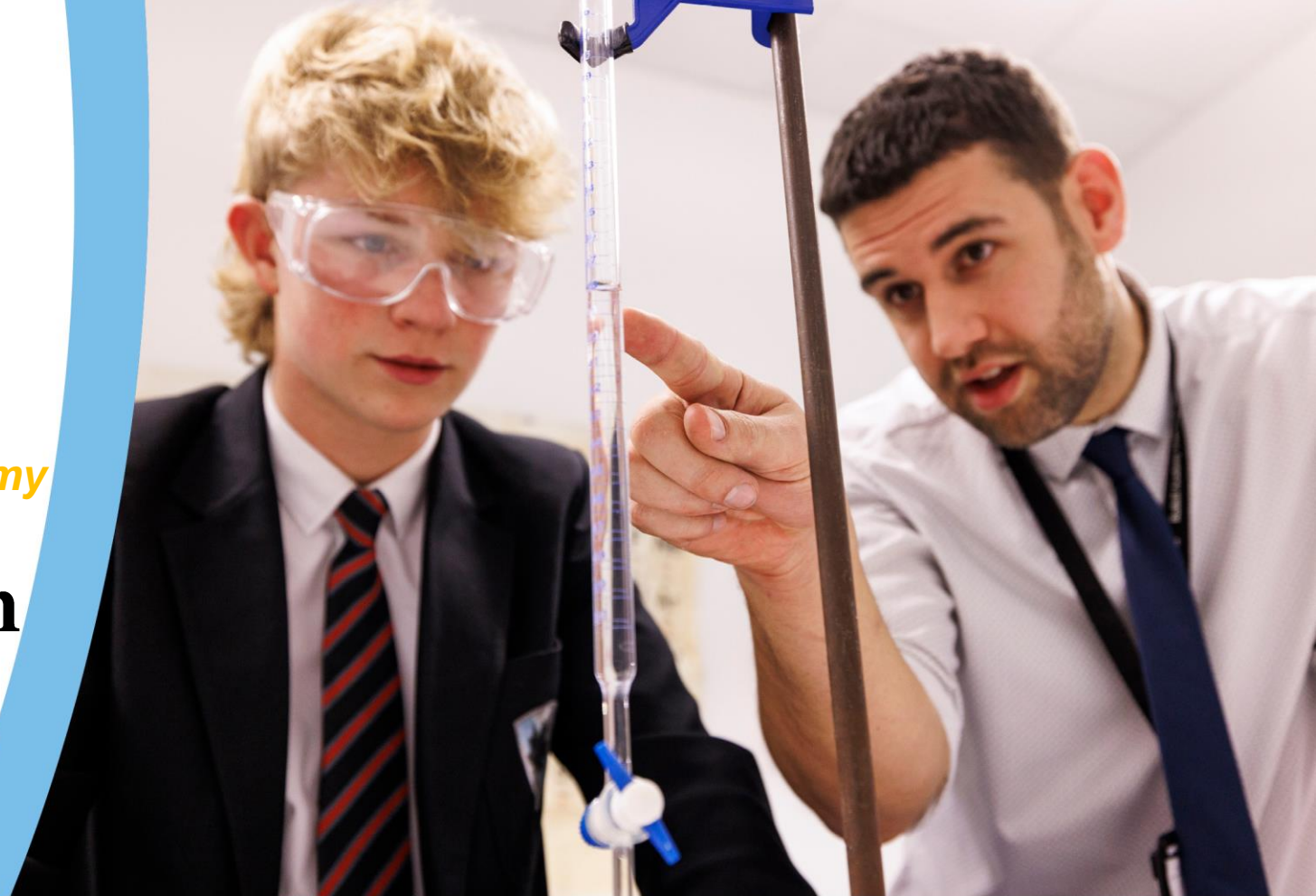



# Welcome



Mr Philpotts

Headteacher

South Nottinghamshire Academy

REDHILL  
ACADEMY TRUST   
Equality and Achievement



# The Senior Leadership Team



Mr Philpotts  
Headteacher



Mr Siviter  
Head of  
School



Mr Watkins  
Deputy  
Headteacher



Mrs Sharpe  
Assistant  
Head



Mr Peyton  
Assistant  
Head



Mrs Cox  
Head of  
Sixth Form



Mr Melfi  
Assistant  
Head



Mrs Cassady  
Associate  
Assistant  
Head:  
SENDCo



# The SNA Way

## The SNA Way (core values)

- Work ethic
- Behaviour
- Uniform
- Homework
- Mobile phones

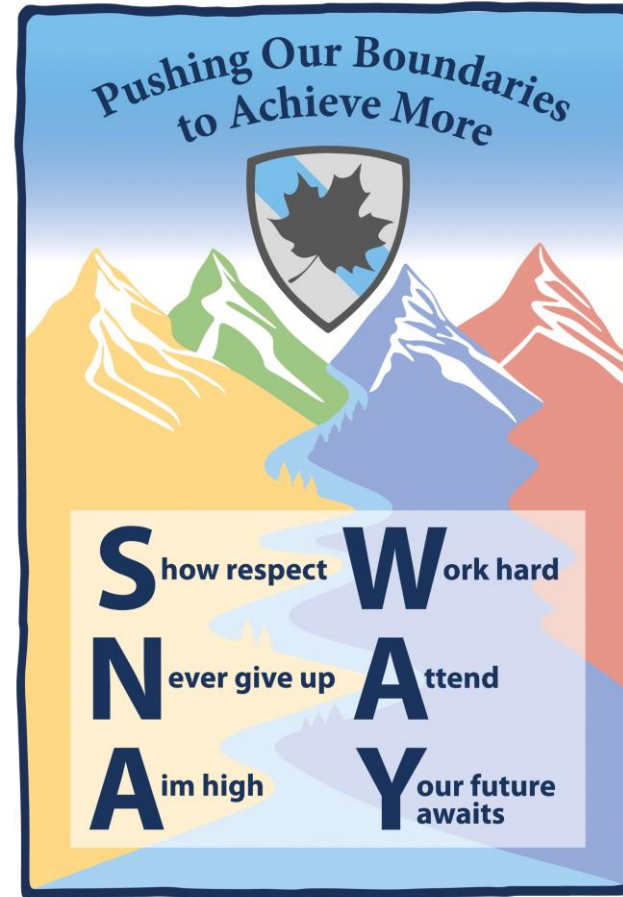

# Academic Achievement



	2019	2022	2023	2024	Difference (to national 2024)
Attainment 8	55.9	55.36	49.47	<b>54</b>	<b>+14</b>
Basics 4+	83%	78%	73%	<b>83%</b>	<b>+18%</b>
Basics 5+	60%	53%	43%	<b>62%</b>	<b>+16%</b>
Average grade	5.61	5.54	4.95	<b>5.40</b>	<b>+1.33</b>
Progress 8	+0.32	+0.38	+0.36	<b>+0.18</b>	<b>+0.18</b>



# Increasing student numbers



	Sep 2020	Sep 2021	Sep 2022	Sep 2023	Sep 2024	Sep 2025
Student numbers	700	767	817	885	970	1,012

We have been **oversubscribed in Year 7 from September 2017** and onwards

We have agreed to admit 180 students into Year 7 in September 2024



# School accommodation



South  
Nottinghamshire  
Academy

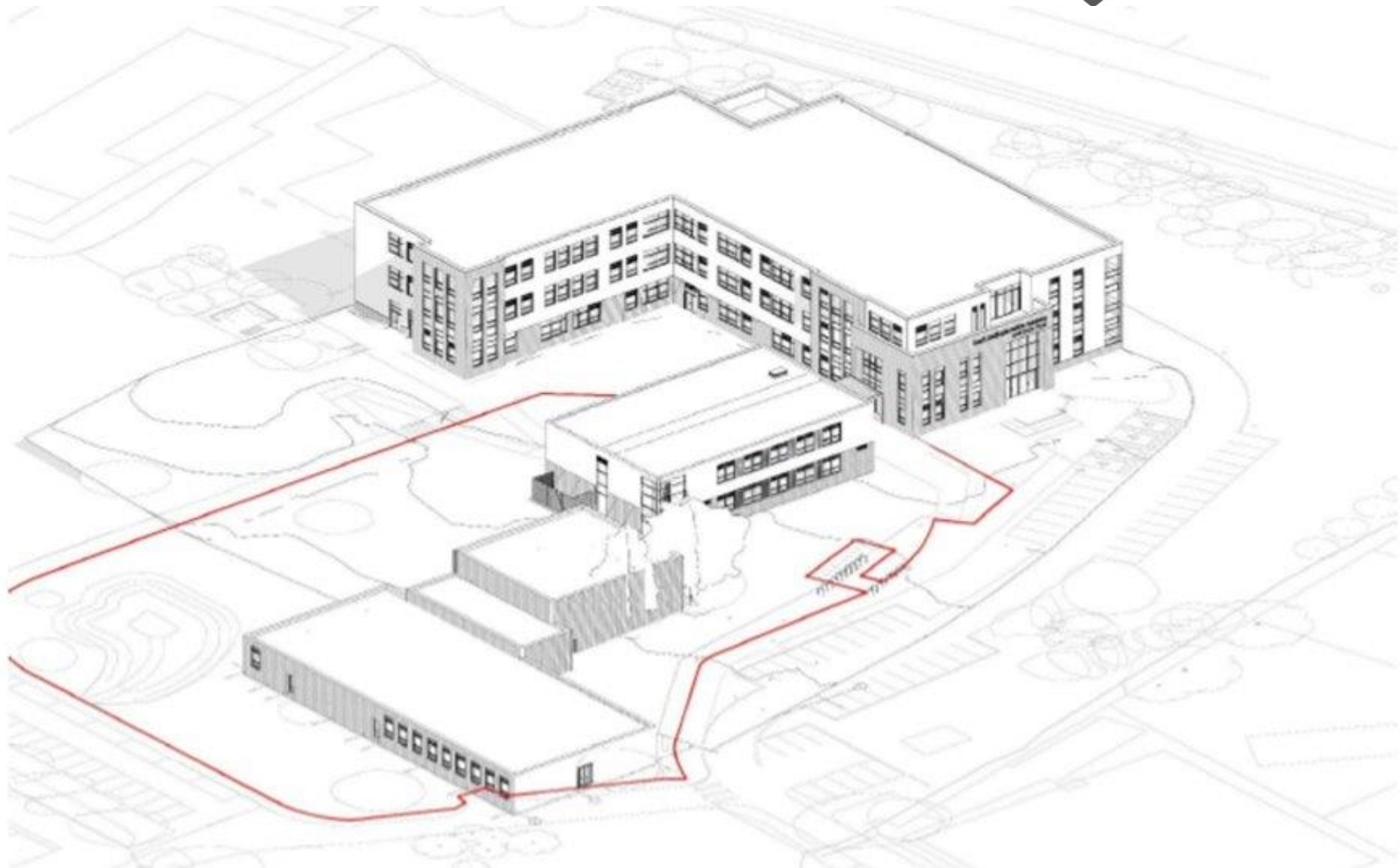

# Mr Watkins

Deputy Headteacher  
South Nottinghamshire Academy



Mr D Watkins  
Deputy Headteacher

REDHILL  
ACADEMY TRUST   
Equality and Achievement





# 'Set high expectations in everything we do'. We expect.....

- Work hard
- Treat each other with respect
- Wear their uniform with pride
- Involve themselves in the wider aspects of academy life
- Maintain a positive learning environment



# House System and Vertical Tutoring

- Head of House and Tutor
- Pastoral support for all students
- Excellent home-school links
- Positive ethos and culture
- House activities
- Increased student responsibility and leadership
- Improved communication
- Better relationships
- Tutor Review meetings

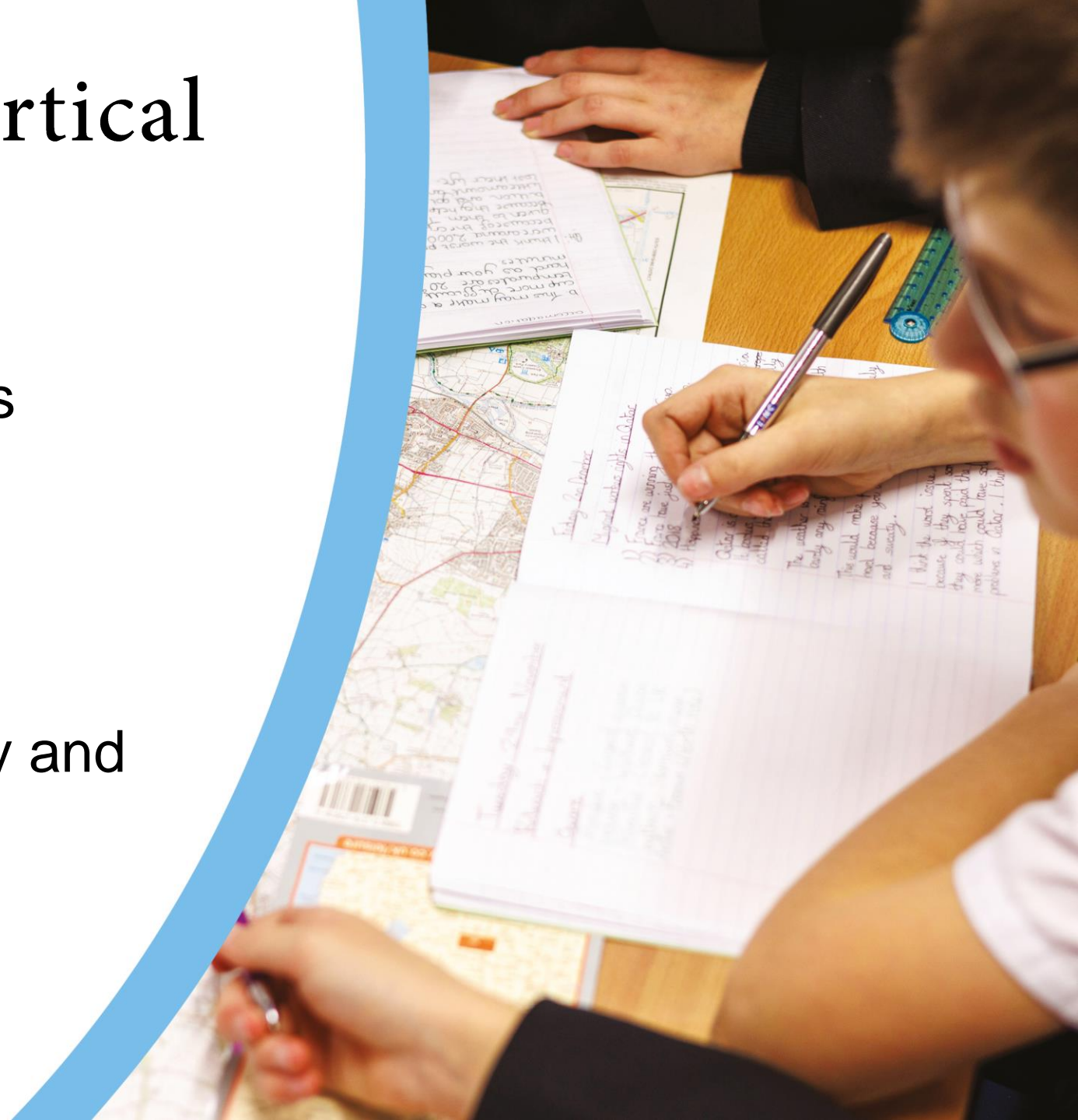

# Heads of House



Mr Lowman



Mrs Blackwell



Mrs Hawksworth



Mr Maggs





# Mr Siviter

Head of School  
South Nottinghamshire Academy



REDHILL  
ACADEMY TRUST   
Equality and Achievement

# A Broad and Balanced Curriculum

By *'pushing our boundaries to achieve more'* and underpinned by our values - the SNA Way - our curriculum vision is to provide academic excellence for all students and to develop them into confident, responsible, independent young people.

Our curriculum is:

Broad and  
Balanced

Inclusive

Sequenced to  
develop literacy,  
numeracy  
and oracy in  
students

Inspiring  
to  
students

Focused on  
developing the  
whole child



# A Broad and Balanced Curriculum

English

Maths

Science

History

Geography

PRE

Spanish &  
French

Technology

Drama

Art

Music

Physical  
Education



# Example Timetable



	Period 1	Period 2	Tutor	Break	Period 3	Lunch	Period 4	Period 5	Twilight
Monday	Science	English	Tutor Time / House Assemblies	Break	Maths	Lunch	French	English	Enrichment and Intervention
Tuesday	French	History			Science		Rotation	Rotation	
Wednesday	Literacy	PE			PE		Maths	English	
Thursday	Geography	Science			Music		Art	Maths	
Friday	French	English			Science		Maths	Geography	



# Setting and Groups

**Year 7 is split into bands X and Y Band**

**All year 7s will study French this year**

**Some Subjects are taught in sets – English, Maths and Science.**

**These are calculated from KS2 data**

**Other subjects are taught in mixed ability classes**

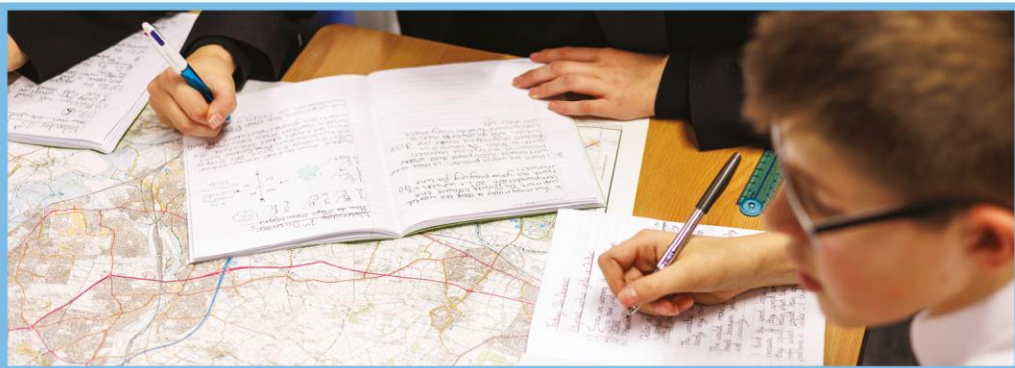



# Homework

## Core Subjects:

- English
- Maths
- Science

## Foundation Subjects:

- Languages
- Geography
- History
- Art
- Music



**ClassCharts**



# Communication

Notifications of homework  
House Points and negative points  
Announcements - trips,  
curriculum+  
Pledges



**ClassCharts**



# Free School Meals

To support students and families who qualify for free school meals, SNA offers:

High quality teaching

A free School uniform in year 7

Outstanding pastoral care

Support for wider opportunities including curriculum trips and visits

Equipment to support learning

For our most vulnerable families, we are also able to offer further social, emotional and financial support through school and wider agencies

**SNA co-ordinator of Pupil Premium: Laura Sharpe**

If you feel your child may qualify for Free School Meals, please contact Nottinghamshire County Council, if you have been in receipt of Free School Meals during primary school, you will have to re-apply before the start of the new academic year.



# Further support

Our dedicated Inclusion and Pastoral teams are on hand to support students navigate their way through secondary education.

## Looked After & Previously Looked after Children



Designated Teacher: Mr Watkins

Please speak to him this evening for further information and to find out how we can support.

## Young Carers

Mrs O'Dowd (Pastoral and Safeguarding Manager)

Can provide information on further support.



# Mobile Phones



SNA approach to Mobile Phones ( from September 2025)

# Mr Peyton

Assistant Headteacher  
South Nottinghamshire Academy



REDHILL  
ACADEMY TRUST   
Equality and Achievement



# Mobile Phones

Current rules: Phones should be switched off and not seen.

If they are seen, then they are confiscated and a lunchtime detention awarded.

However phones still have an impact on our young people.

From September Year 7 will trial a new approach



# Hush Pouches

- Students will be issued a pouch to hold their phone and will be part of their uniform requirements. They will lock their phone in it on arrival.
- This blocks all signals and cannot be unlocked by the students.
- At the end of the day, students access an unlocking magnet to remove their phones.
- For emergencies students can visit school services to access phones.
- Parents should call school to contact students.





# Why we are making this decision



## . Phantom Vibration Syndrome & Mental Distraction

- **Study:** Rosen et al. (2013) found that **even the presence of a phone** nearby, without use, can cause reduced attention and cognitive performance.
- **Effect:** Students may experience "phantom notifications" or be preoccupied with thoughts of what they might be missing, reducing their **working memory** and **focus on learning tasks**.

## Social Media-Induced Anxiety

- **Study:** Vannucci, Flannery & Ohannessian (2017) showed that **fear of missing out (FOMO)** linked to social media causes **anxiety**, which correlates with **poor academic performance**.
- **Even without access**, students distracted by thoughts of social interactions or posts they're not seeing can experience anxiety that lowers **engagement and recall**.

## Internalised Distraction and Habit Formation

- **Concept:** Students may develop **internalised habits of checking and thinking about social media**, similar to addiction pathways.
- **Source:** The concept of "**attention residue**" (Leroy, 2009) explains how incomplete mental shifts from one task (like social media) to another (like learning) degrade performance.

# Mr Melfi

Assistant Headteacher  
South Nottinghamshire Academy



# Co-curricular offer

- A wide range of **personal development opportunities**
- Strong focus on **character education** and living our **SNA Way**
- **Pledge system** helps students grow and reflect on who they are becoming
- **Co-curricular clubs**, sports, performances, and leadership roles for all
- Support to help every student develop confidence, resilience, and ambition



# Beyond the classroom (Curriculum+)

- Students can continue or start lessons on a **musical instrument**
- There are numerous **extra-curricular activities** that are available across the curriculum
- We support **talented students** who are involved in activities outside of school
- Students are involved in **educational visits** and **residential trips** to other countries

*“Pupils in all key stages enjoy wider development opportunities. Many enjoy attending a range of after school clubs” (Ofsted 2022)*



# Beyond the classroom



South  
Nottinghamshire  
Academy

## Overview of Trips 2024-25

	Year 7	Year 8	Year 9	Year 10	Year 11
Autumn 1		<u>Ada Lovelace Science</u>	NTU Inspiring Leaders trip	Dear Evan Hanson (Drama)	Geography physical fieldwork <u>Theddlethorpe Dunes</u>
Autumn 2	National Justice Museum (Y7 themed week)	<u>Willersley Castle</u> (3-day Residential)			
Spring 1			National Holocaust Museum (History)	Careers Capital one Trip	Geography Human Fieldwork Birmingham City Centre
Spring 2				GCSE Science LIVE Triple students	
Summer 1					
Summer Term 2	Dreadlock Alien (English)			Nottingham University (themed week)	
Activities Day	Holme Pierpont	Tamworth Snowdome	Alton Towers	Alton Towers	

# Q & A

**If you have any questions following the presentation, please don't hesitate to ask a member of the Senior Leadership Team, Heads of House or SENCO who will be available in the dining room to help.**



# **This evening:**

## **Drama Studio –**

Uniform fitting

Pencil cases for sale

Calculators for sale

## **Canteen -**

Medical forms and information

Mental health and safeguarding

Catering menu and information

Curriculum + information



# Thank you



South  
Nottinghamshire  
Academy



REDHILL  
ACADEMY TRUST

Equality and Achievement

